

# Freestanding STOVE ORBIT

KOZA/ORBIT

EAN:

5903950011964

Stove ORBIT with cylindrical, modern design is a great solution for people who long for warmth, but do not have a large space in their interior.



## Technical Specifications

Rated output (kW)	7,0
Range of heating power (kW)	5.5 - 9.0
Efficiency (%)	76,0
Exhaust outlet diameter (mm)	150
Complies with Ecodesign criteria	No
Designed for heat recovery unit	No
Fuel type	recommended seasoned hardwood with moisture $\leq 20\%$
Weight (kg)	99,0
CO emission (at 13% O <sub>2</sub> ) $\leq$ given in %	0,09
Flue gas temperature (°C)	250,0
Max log length (cm)	25
Emission of dust (mg/Nm <sup>3</sup> )	40,0
Compliance with BlmSchV 2 standard	Yes
The energy efficiency index EEI	100,18
Glazing type	quadrant
Opening of the doors	to the left
Material	steel
Width (cm)	47,50

Height (cm)	91,40
Depth (cm)	57,00
External air inlet	No
The liner of the combustion chamber	Yes
Ashpan	Yes
Decorative printed glass	No
ASDP - automatic control of the air supply	No
Turbine TURBOFAN	No
Water panel	No

## Features

---

### MAXIMUM ENERGY USE

The body and the front of the insert are resistant to high temperatures thanks to the high quality steel used in production.

Combustion of fuel thanks to the Acumotte deflector.

Triple air system of combustion chamber: primary air - directed to the grate; secondary air supplied by the holes located in the back wall. Additionally, the system of air clean glass has been applied (curtain air). Moreover this air curtain is equipped with additional lever to regulate it.

Efficient burning process & maintaining of temperature to keep the warmth for longer thanks to lining of combustion chamber with Acumotte - heat accumulating material which raises the temperature in the combustion chamber.

Adjusting the external air inlet corresponding to the intensity of burning by using a single regulator, which is below the oven door.

### SAFETY AT ITS BEST

Perfect tightness thanks to the solid welds made in a noble gas shielding.

All steel elements are laser cut and bent on CNC bending machines.

Insert's front equipped with a heat resistant ceramics that withstands temperatures up to 800°C.

### CONVENIENCE

Movable grate and ashpan enables to clean the insert.

Reduced soot deposition through a system of pure glass (air curtain).

An elegant and comfortable handle.

It can be used in a various mounting conditions thanks to adjustable exhaust outlet: on the back or top of the stove (for back exhaust outlet installation purchase of top plate cover is required).

## MODERN DESIGN

Improved vision of the fire thanks to the curved glass.

Modern cylindrical shape.

5 year warranty.

## Technical drawing

---

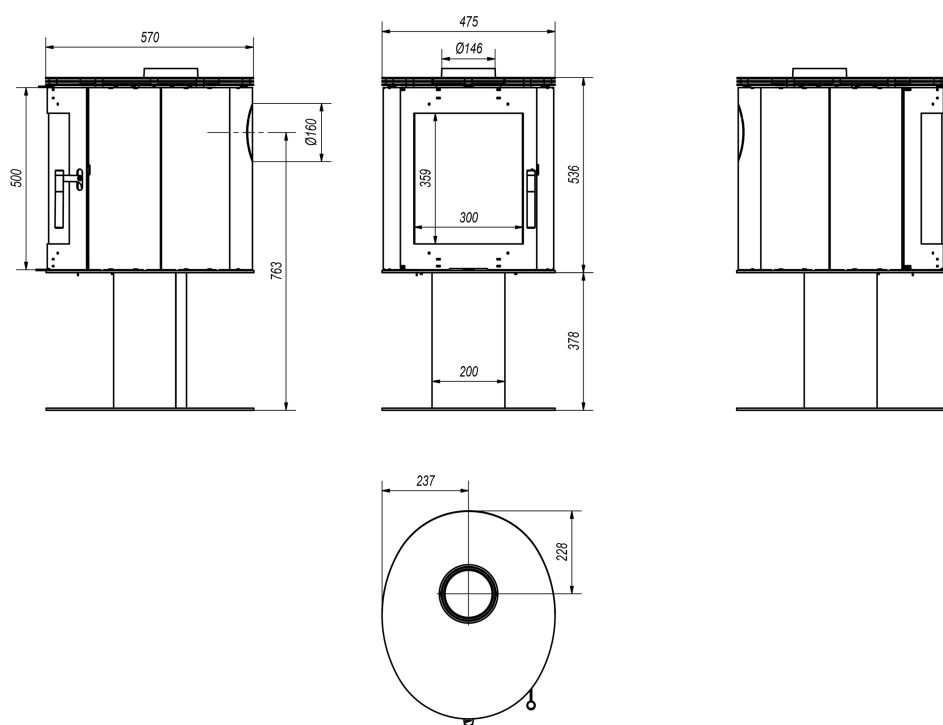

## Additional options

---



Top plate cover for STOVE K5

20,00 zł



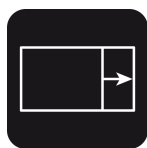

Top plate cover for STOVE K5 is required for back exhaust outlet installation.



Spring for door shutting AB S/2,  
ORBIT MB

120,00 zł

Spring for door shutting - automatically closes the door.

	<p><b>Steel pipe 150/1m</b></p> <p>Exhaust pipe designed for connecting wood-fired fireplace inserts an the existing flue pipes.</p>	86,00 zł
	<p><b>Steel pipe 150/0.5m</b></p> <p>Exhaust pipe designed for connecting wood-fired fireplace inserts an the existing flue pipes.</p>	58,00 zł
	<p><b>Movable elbow 150/90</b></p> <p>Adjustable elbow up to 90°, 3-segment, diameter: 150 mm.</p>	90,00 zł
	<p><b>Damper Ø 150 black</b></p> <p>The damper is designed to regulate the smoke draft.</p>	90,00 zł
	<p><b>Steel rosette Ø 150</b></p> <p>Rosette Ø 150, made of black sheet - a masking element.</p>	17,00 zł



**Kratki.pl Marek Bal**  
 ul. W. Gombrowicza 4  
 26-660 Wsola/Jedlińsk

**www.kratki.com**  
 +48 48 338 44 88

Date of publication:  
 08.09.2018