

Freestanding STOVE AB S/N/DR GLASS

KOZA/AB/S/N/DR/GLASS

EAN:

5903950073832

Stove AB with cylindrical, modern design is a great solution for people who long for warmth, but do not have a large space in their interior.



Technical Specifications

Rated output (kW)	8,0
Range of heating power (kW)	5.5 - 10.5
Efficiency (%)	78,0
Exhaust outlet diameter (mm)	150
Complies with Ecodesign criteria	Yes
Designed for heat recovery unit	Yes
Fuel type	recommended seasoned hardwood with moisture $\leq 20\%$
CO emission (at 13% O ₂) \leq given in %	0,08
Flue gas temperature (°C)	265,0
Max log length (cm)	25
Emission of dust (mg/Nm ³)	39,0
Compliance with BlmSchV 2 standard	Yes
The energy efficiency index EEI	102,79
Glazing type	quadrant
Opening of the doors	to the left
Material	steel

Width (cm)	52,80
Height (cm)	108,60
Depth (cm)	42,20
External air inlet	Yes
The liner of the combustion chamber	Yes
Ashpan	Yes
Decorative printed glass	Yes
ASDP - automatic control of the air supply	No
Turbine TURBOFAN	No
Water panel	No

Features

MAXIMUM USE OF ENERGY

The body and the front of the insert are resistant to high temperatures thanks to the high quality steel used in production.

Full combustion on the dust thanks to two deflectors (steel and Acumotte) extending the exhaust path.

Triple system of combustion chamber's air venting: primary air - secondary air supplied under the grate through holes in a back wall. Additionally clean glass system designed (air curtain).

Efficient burning process & maintaining of temperature to keep the warmth for longer thanks to lining of combustion chamber with Acumotte - heat accumulating material which raises the temperature in the combustion chamber.

Built-in fi 100 external air intake which provides air supply from the outside directly into the hearth which results in better combustion and better comfort of usage.

SAFETY AT THE HIGHEST LEVEL

Perfect tightness thanks to the solid welds made in a noble gas shielding.

All steel elements are laser cut and bent on CNC bending machines.

Insert's front equipped with a heat resistant ceramics that withstands temperatures up to 800oC.

CONVENIENT TO USE

Comfortable ash removal thanks to rotating grate.

Reduced soot deposition through a system of pure glass (air curtain).

Elegant and comfortable sliding handle.

It can be used in a various mounting conditions thanks to adjustable exhaust outlet: on the back or top of the stove (for back exhaust outlet installation purchase of top plate cover is required).

MODERN DESIGN

Decorative, heat-resistant glass that can withstand temperatures up to 800oC. It gives a fireplace a modern and elegant look, visually enlarges the front of the insert.

Improved vision of the fire thanks to the curved glass

5 year warranty.

Technical drawing

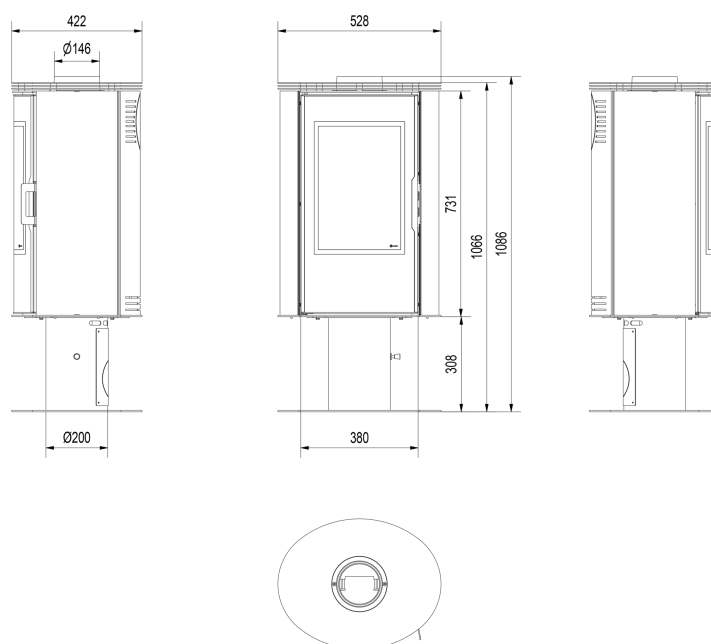

Additional options



Top plate cover for STOVE AB S,
THOR, FALCON, ANTARES

20,00 zł

Top plate cover for STOVE AB S, STOVE AB S/2,
THOR, THOR/VIEW, FALCON, FALCON/VIEW,
ANTARES is required for back exhaust outlet
installation.

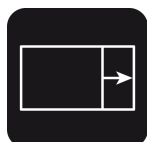





Spring for door shutting AB S
GLASS

120,00 zł

Spring for door shutting - automatically closes the

door.

	Steel pipe 150/1m Exhaust pipe designed for connecting wood-fired fireplace inserts an the existing flue pipes.	86,00 zł
	Steel pipe 150/0.5m Exhaust pipe designed for connecting wood-fired fireplace inserts an the existing flue pipes.	58,00 zł
	Movable elbow 150/90 Adjustable elbow up to 90°, 3-segment, diameter: 150 mm.	90,00 zł
	Damper Ø 150 black The damper is designed to regulate the smoke draft.	90,00 zł
	Steel rosette Ø 150 Rosette Ø 150, made of black sheet - a masking element.	17,00 zł

Return

Klient będący Konsumentem, który zawarł Umowę sprzedaży, może w terminie 14 dni odstąpić od niej bez podawania przyczyny. Bieg terminu na odstąpienie od Umowy sprzedaży rozpoczyna się od chwili objęcia Towaru w posiadanie przez Klienta lub wskazaną przez niego osobę trzecią inną niż przewoźnik. Oświadczenie można złożyć na formularzu, którego wzór został zamieszczony przez Sprzedawcę na Stronie Internetowej Sklepu pod adresem: **formularz odstąpienia**.



Kratki.pl Marek Bal
ul. W. Gombrowicza 4
26-660 Wsola/Jedlińsk

www.kratki.com
+48 48 338 44 88

Date of publication:
08.09.2018